

LF1206C202R-10

UNCONTROLLED DOCUMENT

PHYSICAL DIMENSIONS:

A	3.20 [.126]	+ 0.20 [.008]
B	1.60 [.063]	+ 0.20 [.008]
C	1.10 [.043]	+ 0.20 [.008]
D	0.51 [.020]	+ 0.25 [.010]

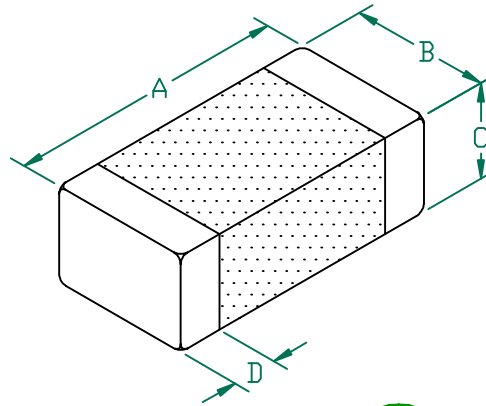

ELECTRICAL CHARACTERISTICS:			
Z @ 30MHz (Ω)	DCR (Ω)	Rated Current	
Nominal	2000		
Minimum	1500		
Maximum	2500	0.50	300 mA

Z vs FREQUENCY
IMPEDANCE UNDER DC BIAS

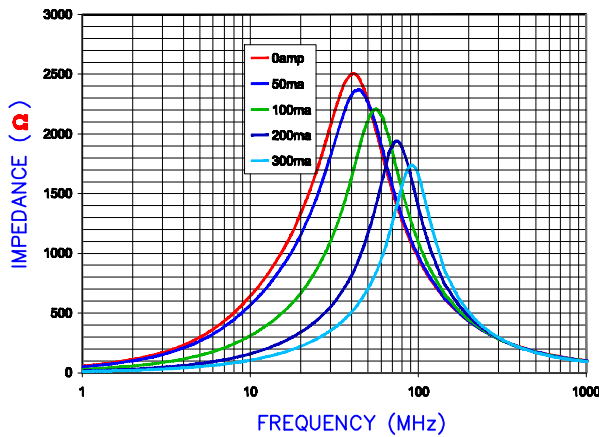

LAND PATTERNS FOR REFLOW SOLDERING

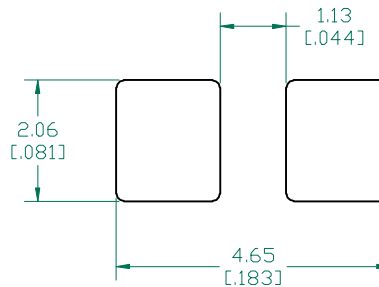

(For wave soldering, add 0.762 [.030] to this dimension)

RECOMMENDED SOLDERING CONDITIONS

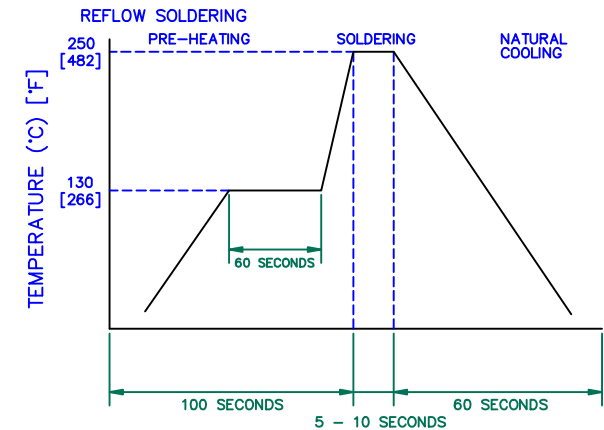

|Z|, R, AND X vs. FREQUENCY

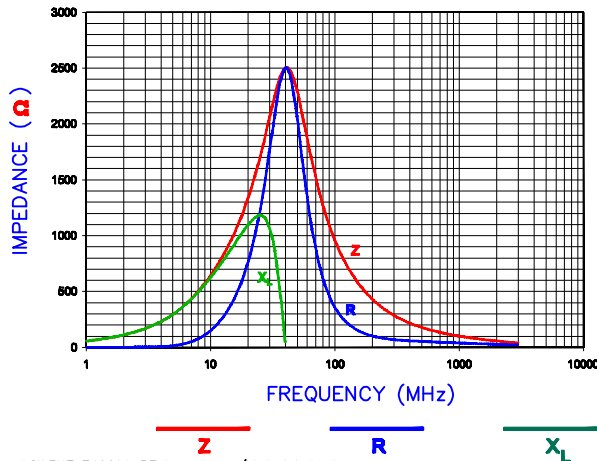

DIMENSIONS ARE IN mm [INCHES]				This print is the property of Laird Tech. and is loaned in confidence subject to return upon request and with the understanding that no copies shall be made without the written consent of Laird Tech. All rights to design or invention are reserved.			
				PROJECT/PART NUMBER:	REV	PART TYPE:	DRAWN BY:
				LF1206C202R-10	B	CO-FIRE	JRK
B	UPDATE COMPANY LOGO	07/08/08	JRK	DATE:	09/13/06	SCALE:	NTS
A	ORIGINAL DRAFT	09/13/06	JRK	GAD #		SHEET:	2 of 2
REV	DESCRIPTION	DATE	INT	LF1206C202R-10-B			